

OESCH GMBH
 Adlerstrasse 25
 Postfach 23
 CH-4312 Magden

Telefon +41 61 841 03 33
 Fax +41 61 841 03 30
 info@oeschswitzerland.com
 www.oeschswitzerland.com

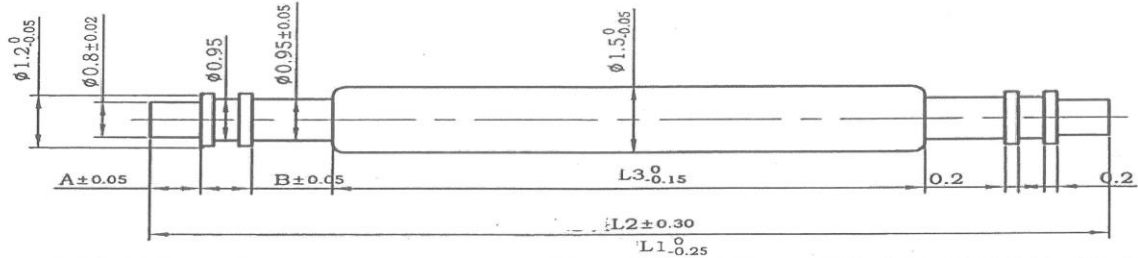

Part NO.	Description	L1	L2	L3	A	B					
41-320-150060	SDF-150S 6 mm	6.0	7.3	3.9	0.5	0.5	5.5mm	6.0mm	Ø 1.5x0.13x3.9	Ø 1.2 05-05-09-04+06	304J 37# Ø 1.1x3.5mm
41-320-150065	SDF-150S 6.5mm	6.5	7.8	4.4	0.5	0.5	6.0mm	6.5mm	Ø 1.5x0.13x4.4	Ø 1.2 05-05-09-04+06	304J 37# Ø 1.1x4.0mm
41-320-150070	SDF-150S 7mm	7.0	8.7	4.5	0.7	0.5	6.5mm	7.0mm	Ø 1.5x0.13x4.5	Ø 1.2 07-05-11-04+07	304J 37# Ø 1.1x4.0mm
41-320-150075	SDF-150S 7.5mm	7.5	9.2	5.0	0.7	0.5	7.0mm	7.5mm	Ø 1.5x0.13x5.0	Ø 1.2 07-05-11-04+07	304J 37# Ø 1.1x4.5mm
41-320-150080	SDF-150S 8mm	8.0	9.7	5.1	0.7	0.7	7.5mm	8.0mm	Ø 1.5x0.13x5.1	Ø 1.2 07-07-11-06+07	304J 37# Ø 1.1x4.5mm
41-320-150085	SDF-150S 8.5mm	8.5	10.2	5.6	0.7	0.7	8.0mm	8.5mm	Ø 1.5x0.13x5.6	Ø 1.2 07-07-11-06+07	304J 35# Ø 1.1x5.0mm
41-320-150090	SDF-150S 9mm	9.0	10.7	6.1	0.7	0.7	8.5mm	9.0mm	Ø 1.5x0.13x6.1	Ø 1.2 07-07-11-09	304J 35# Ø 1.1x5.0mm
41-320-150095	SDF-150S 9.5mm	9.5	11.2	6.6	0.7	0.7	9.0mm	9.5mm	Ø 1.5x0.13x6.6	Ø 1.2 07-07-11-09	304J 35# Ø 1.1x5.5mm
41-320-150100	SDF-150S 10mm	10.0	11.7	7.1	0.7	0.7	9.5mm	10mm	Ø 1.5x0.13x7.1	Ø 1.2 07-07-11-09	304J 35# Ø 1.1x6.0mm
41-320-150105	SDF-150S 10.5mm	10.5	12.6	7.6	0.7	0.7	10mm	10.5mm	Ø 1.5x0.13x7.6	Ø 1.2 07-07-13-12	304J 35# Ø 1.1x6.0mm
41-320-150110	SDF-150S 11mm	11.0	13.1	8.1	0.7	0.7	10.5mm	11mm	Ø 1.5x0.13x8.1	Ø 1.2 07-07-13-12	304J 35# Ø 1.1x6.5mm
41-320-150115	SDF-150S 11.5mm	11.5	13.6	8.6	0.7	0.7	11mm	11.5mm	Ø 1.5x0.13x8.6	Ø 1.2 07-07-13-12	304J 35# Ø 1.1x7.0mm
41-320-150120	SDF-150S 12mm	12.0	14.1	9.1	0.8	0.8	11.5mm	12mm	Ø 1.5x0.13x9.1	Ø 1.2 07-07-13-12	304J 35# Ø 1.1x7.5mm
41-320-150125	SDF-150S 12.5mm	12.5	15.0	9.2	0.8	0.8	12mm	12.5mm	Ø 1.5x0.13x9.2	Ø 1.2 08-08-15-16	304J 35# Ø 1.1x7.5mm
41-320-150130	SDF-150S 13mm	13.0	15.5	9.7	0.8	0.8	12.5mm	13mm	Ø 1.5x0.13x9.7	Ø 1.2 08-08-15-16	304J 35# Ø 1.1x8.0mm
41-320-150135	SDF-150S 13.5mm	13.5	16.0	10.2	0.8	0.8	13mm	13.5mm	Ø 1.5x0.13x10.2	Ø 1.2 08-08-15-16	304C 35# Ø 1.1x8.5mm
41-320-150140	SDF-150S 14mm	14.0	16.5	10.7	0.8	0.8	13.5mm	14mm	Ø 1.5x0.13x10.7	Ø 1.2 08-08-15-16	304C 35# Ø 1.1x9.0mm
41-320-150145	SDF-150S 14.5mm	14.5	17.0	11.2	0.8	0.8	14mm	14.5mm	Ø 1.5x0.13x11.2	Ø 1.2 08-08-15-16	304C 35# Ø 1.1x9.5mm
41-320-150150	SDF-150S 15mm	15.0	17.5	11.7	0.8	0.8	14.5mm	15mm	Ø 1.5x0.13x11.7	Ø 1.2 08-08-15-16	304C 35# Ø 1.1x10mm
41-320-150155	SDF-150S 15.5mm	15.5	18.0	12.2	0.8	0.8	15mm	15.5mm	Ø 1.5x0.13x12.2	Ø 1.2 08-08-15-16	304C 35# Ø 1.1x10.5mm
41-320-150160	SDF-150S 16mm	16.0	19.1	12.7	0.8	0.8	15.5mm	16mm	Ø 1.5x0.11x12.7	Ø 1.2 08-08-18-20	304C 35# Ø 1.1x10.5mm
41-320-150165	SDF-150S 16.5mm	16.5	19.6	13.2	0.8	0.8	16mm	16.5mm	Ø 1.5x0.11x13.2	Ø 1.2 08-08-18-20	304C 35# Ø 1.1x11mm
41-320-150170	SDF-150S 17mm	17.0	20.1	13.7	0.8	0.8	16.5mm	17mm	Ø 1.5x0.11x13.7	Ø 1.2 08-08-18-20	304C 35# Ø 1.1x11.5mm
41-320-150175	SDF-150S 17.5mm	17.5	20.6	14.2	0.8	0.8	17mm	17.5mm	Ø 1.5x0.11x14.2	Ø 1.2 08-08-18-20	304C 35# Ø 1.1x12mm
41-320-150180	SDF-150S 18mm	18.0	21.1	14.7	0.8	0.8	17.5mm	18mm	Ø 1.5x0.11x14.7	Ø 1.2 08-08-18-20	304C 35# Ø 1.1x12.5mm
41-320-150185	SDF-150S 18.5mm	18.5	21.6	15.2	0.8	0.8	18mm	18.5mm	Ø 1.5x0.11x15.2	Ø 1.2 08-08-18-20	304C 35# Ø 1.1x13mm
41-320-150190	SDF-150S 19mm	19.0	22.1	15.7	0.8	0.8	18.5mm	19mm	Ø 1.5x0.11x15.7	Ø 1.2 08-08-18-20	304C 35# Ø 1.1x13.5mm
41-320-150195	SDF-150S 19.5mm	19.5	22.6	16.2	0.8	0.8	19mm	19.5mm	Ø 1.5x0.11x16.2	Ø 1.2 08-08-18-20	304C 35# Ø 1.1x14mm
41-320-150200	SDF-150S 20mm	20.0	23.1	16.7	0.8	0.8	19.5mm	20mm	Ø 1.5x0.11x16.7	Ø 1.2 08-08-18-20	304C 35# Ø 1.1x14.5mm
41-320-150205	SDF-150S 20.5mm	20.5	23.6	17.2	0.8	0.8	20mm	20.5mm	Ø 1.5x0.11x17.2	Ø 1.2 08-08-18-20	304C 35# Ø 1.1x15mm
41-320-150210	SDF-150S 21mm	21.0	24.1	17.7	0.8	0.8	20.5mm	21mm	Ø 1.5x0.11x17.7	Ø 1.2 08-08-18-20	304C 35# Ø 1.1x15.5mm
41-320-150215	SDF-150S 21.5mm	21.5	24.6	18.2	0.8	0.8	21mm	21.5mm	Ø 1.5x0.11x18.2	Ø 1.2 08-08-18-20	304C 35# Ø 1.1x16mm
41-320-150220	SDF-150S 22mm	22.0	25.1	18.7	0.8	0.8	21.5mm	22mm	Ø 1.5x0.11x18.7	Ø 1.2 08-08-18-20	304C 35# Ø 1.1x16.5mm
41-320-150225	SDF-150S 22.5mm	22.5	25.6	19.2	0.8	0.8	22mm	22.5mm	Ø 1.5x0.11x19.2	Ø 1.2 08-08-18-20	304C 35# Ø 1.1x17mm
41-320-150230	SDF-150S 23mm	23.0	26.1	19.7	0.8	0.8	22.5mm	23mm	Ø 1.5x0.11x19.7	Ø 1.2 08-08-18-20	304C 35# Ø 1.1x17.5mm
41-320-150235	SDF-150S 23.5mm	23.5	26.6	20.2	0.8	0.8	23mm	23.5mm	Ø 1.5x0.11x20.2	Ø 1.2 08-08-18-20	304C 35# Ø 1.1x18mm
41-320-150240	SDF-150S 24mm	24.0	27.1	20.7	0.8	0.8	23.5mm	24mm	Ø 1.5x0.11x20.7	Ø 1.2 08-08-18-20	304C 35# Ø 1.1x18.5mm
41-320-150245	SDF-150S 24.5mm	24.5	27.6	21.2	0.8	0.8	24mm	24.5mm	Ø 1.5x0.11x21.2	Ø 1.2 08-08-18-20	304C 35# Ø 1.1x19mm

	Object	Standard spring bar 5010.01		Drawing from	UN	Date	24.02.2005
	Drawing #		Unit	mm	Confirmation	Date	
	Material	Stainless steel 304					