

OESCH GMBH
 Adlerstrasse 25
 Postfach 23
 CH-4312 Magden

Telefon +41 61 841 03 33
 Fax +41 61 841 03 30
 info@oeschswitzerland.com
 www.oeschswitzerland.com

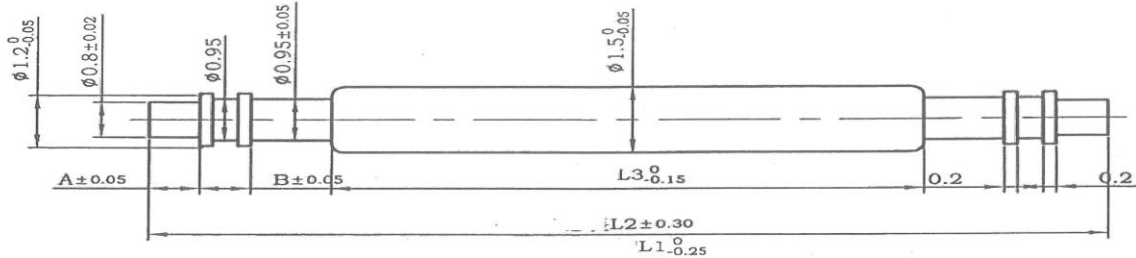

| Part NO. | Description | L1 | L2 | L3 | A | B | | | | | |
|---------------|-----------------|------|------|------|-----|-----|--------|--------|---------------|--------------------|---------------------|
| 41-320-150060 | SDF-150S 6 mm | 6.0 | 7.3 | 3.9 | 0.5 | 0.5 | 5.5mm | 6.0mm | 1.5x0.13x3.9 | 1.2 05-05-09-04+06 | 304J 37# 1.1x3.5mm |
| 41-320-150065 | SDF-150S 6.5mm | 6.5 | 7.8 | 4.4 | 0.5 | 0.5 | 6.0mm | 6.5mm | 1.5x0.13x4.4 | 1.2 05-05-09-04+06 | 304J 37# 1.1x4.0mm |
| 41-320-150070 | SDF-150S 7mm | 7.0 | 8.7 | 4.5 | 0.7 | 0.5 | 6.5mm | 7.0mm | 1.5x0.13x4.5 | 1.2 07-05-11-04+07 | 304J 37# 1.1x4.0mm |
| 41-320-150075 | SDF-150S 7.5mm | 7.5 | 9.2 | 5.0 | 0.7 | 0.5 | 7.0mm | 7.5mm | 1.5x0.13x5.0 | 1.2 07-05-11-04+07 | 304J 37# 1.1x4.5mm |
| 41-320-150080 | SDF-150S 8mm | 8.0 | 9.7 | 5.1 | 0.7 | 0.7 | 7.5mm | 8.0mm | 1.5x0.13x5.1 | 1.2 07-07-11-06+07 | 304J 37# 1.1x4.5mm |
| 41-320-150085 | SDF-150S 8.5mm | 8.5 | 10.2 | 5.6 | 0.7 | 0.7 | 8.0mm | 8.5mm | 1.5x0.13x5.6 | 1.2 07-07-11-06+07 | 304J 35# 1.1x5.0mm |
| 41-320-150090 | SDF-150S 9mm | 9.0 | 10.7 | 6.1 | 0.7 | 0.7 | 8.5mm | 9.0mm | 1.5x0.13x6.1 | 1.2 07-07-11-09 | 304J 35# 1.1x5.0mm |
| 41-320-150095 | SDF-150S 9.5mm | 9.5 | 11.2 | 6.6 | 0.7 | 0.7 | 9.0mm | 9.5mm | 1.5x0.13x6.6 | 1.2 07-07-11-09 | 304J 35# 1.1x5.5mm |
| 41-320-150100 | SDF-150S 10mm | 10.0 | 11.7 | 7.1 | 0.7 | 0.7 | 9.5mm | 10mm | 1.5x0.13x7.1 | 1.2 07-07-11-09 | 304J 35# 1.1x6.0mm |
| 41-320-150105 | SDF-150S 10.5mm | 10.5 | 12.6 | 7.6 | 0.7 | 0.7 | 10mm | 10.5mm | 1.5x0.13x7.6 | 1.2 07-07-13-12 | 304J 35# 1.1x6.0mm |
| 41-320-150110 | SDF-150S 11mm | 11.0 | 13.1 | 8.1 | 0.7 | 0.7 | 10.5mm | 11mm | 1.5x0.13x8.1 | 1.2 07-07-13-12 | 304J 35# 1.1x6.5mm |
| 41-320-150115 | SDF-150S 11.5mm | 11.5 | 13.6 | 8.6 | 0.7 | 0.7 | 11mm | 11.5mm | 1.5x0.13x8.6 | 1.2 07-07-13-12 | 304J 35# 1.1x7.0mm |
| 41-320-150120 | SDF-150S 12mm | 12.0 | 14.1 | 9.1 | 0.8 | 0.8 | 11.5mm | 12mm | 1.5x0.13x9.1 | 1.2 07-07-13-12 | 304J 35# 1.1x7.5mm |
| 41-320-150125 | SDF-150S 12.5mm | 12.5 | 15.0 | 9.2 | 0.8 | 0.8 | 12mm | 12.5mm | 1.5x0.13x9.2 | 1.2 08-08-15-16 | 304J 35# 1.1x7.5mm |
| 41-320-150130 | SDF-150S 13mm | 13.0 | 15.5 | 9.7 | 0.8 | 0.8 | 12.5mm | 13mm | 1.5x0.13x9.7 | 1.2 08-08-15-16 | 304J 35# 1.1x8.0mm |
| 41-320-150135 | SDF-150S 13.5mm | 13.5 | 16.0 | 10.2 | 0.8 | 0.8 | 13mm | 13.5mm | 1.5x0.13x10.2 | 1.2 08-08-15-16 | 304C 35# 1.1x8.5mm |
| 41-320-150140 | SDF-150S 14mm | 14.0 | 16.5 | 10.7 | 0.8 | 0.8 | 13.5mm | 14mm | 1.5x0.13x10.7 | 1.2 08-08-15-16 | 304C 35# 1.1x9.0mm |
| 41-320-150145 | SDF-150S 14.5mm | 14.5 | 17.0 | 11.2 | 0.8 | 0.8 | 14mm | 14.5mm | 1.5x0.13x11.2 | 1.2 08-08-15-16 | 304C 35# 1.1x9.5mm |
| 41-320-150150 | SDF-150S 15mm | 15.0 | 17.5 | 11.7 | 0.8 | 0.8 | 14.5mm | 15mm | 1.5x0.13x11.7 | 1.2 08-08-15-16 | 304C 35# 1.1x10mm |
| 41-320-150155 | SDF-150S 15.5mm | 15.5 | 18.0 | 12.2 | 0.8 | 0.8 | 15mm | 15.5mm | 1.5x0.13x12.2 | 1.2 08-08-15-16 | 304C 35# 1.1x10.5mm |
| 41-320-150160 | SDF-150S 16mm | 16.0 | 19.1 | 12.7 | 0.8 | 0.8 | 15.5mm | 16mm | 1.5x0.11x12.7 | 1.2 08-08-18-20 | 304C 35# 1.1x10.5mm |
| 41-320-150165 | SDF-150S 16.5mm | 16.5 | 19.6 | 13.2 | 0.8 | 0.8 | 16mm | 16.5mm | 1.5x0.11x13.2 | 1.2 08-08-18-20 | 304C 35# 1.1x11mm |
| 41-320-150170 | SDF-150S 17mm | 17.0 | 20.1 | 13.7 | 0.8 | 0.8 | 16.5mm | 17mm | 1.5x0.11x13.7 | 1.2 08-08-18-20 | 304C 35# 1.1x11.5mm |
| 41-320-150175 | SDF-150S 17.5mm | 17.5 | 20.6 | 14.2 | 0.8 | 0.8 | 17mm | 17.5mm | 1.5x0.11x14.2 | 1.2 08-08-18-20 | 304C 35# 1.1x12mm |
| 41-320-150180 | SDF-150S 18mm | 18.0 | 21.1 | 14.7 | 0.8 | 0.8 | 17.5mm | 18mm | 1.5x0.11x14.7 | 1.2 08-08-18-20 | 304C 35# 1.1x12.5mm |
| 41-320-150185 | SDF-150S 18.5mm | 18.5 | 21.6 | 15.2 | 0.8 | 0.8 | 18mm | 18.5mm | 1.5x0.11x15.2 | 1.2 08-08-18-20 | 304C 35# 1.1x13mm |
| 41-320-150190 | SDF-150S 19mm | 19.0 | 22.1 | 15.7 | 0.8 | 0.8 | 18.5mm | 19mm | 1.5x0.11x15.7 | 1.2 08-08-18-20 | 304C 35# 1.1x13.5mm |
| 41-320-150195 | SDF-150S 19.5mm | 19.5 | 22.6 | 16.2 | 0.8 | 0.8 | 19mm | 19.5mm | 1.5x0.11x16.2 | 1.2 08-08-18-20 | 304C 35# 1.1x14mm |
| 41-320-150200 | SDF-150S 20mm | 20.0 | 23.1 | 16.7 | 0.8 | 0.8 | 19.5mm | 20mm | 1.5x0.11x16.7 | 1.2 08-08-18-20 | 304C 35# 1.1x14.5mm |
| 41-320-150205 | SDF-150S 20.5mm | 20.5 | 23.6 | 17.2 | 0.8 | 0.8 | 20mm | 20.5mm | 1.5x0.11x17.2 | 1.2 08-08-18-20 | 304C 35# 1.1x15mm |
| 41-320-150210 | SDF-150S 21mm | 21.0 | 24.1 | 17.7 | 0.8 | 0.8 | 20.5mm | 21mm | 1.5x0.11x17.7 | 1.2 08-08-18-20 | 304C 35# 1.1x15.5mm |
| 41-320-150215 | SDF-150S 21.5mm | 21.5 | 24.6 | 18.2 | 0.8 | 0.8 | 21mm | 21.5mm | 1.5x0.11x18.2 | 1.2 08-08-18-20 | 304C 35# 1.1x16mm |
| 41-320-150220 | SDF-150S 22mm | 22.0 | 25.1 | 18.7 | 0.8 | 0.8 | 21.5mm | 22mm | 1.5x0.11x18.7 | 1.2 08-08-18-20 | 304C 35# 1.1x16.5mm |
| 41-320-150225 | SDF-150S 22.5mm | 22.5 | 25.6 | 19.2 | 0.8 | 0.8 | 22mm | 22.5mm | 1.5x0.11x19.2 | 1.2 08-08-18-20 | 304C 35# 1.1x17mm |
| 41-320-150230 | SDF-150S 23mm | 23.0 | 26.1 | 19.7 | 0.8 | 0.8 | 22.5mm | 23mm | 1.5x0.11x19.7 | 1.2 08-08-18-20 | 304C 35# 1.1x17.5mm |
| 41-320-150235 | SDF-150S 23.5mm | 23.5 | 26.6 | 20.2 | 0.8 | 0.8 | 23mm | 23.5mm | 1.5x0.11x20.2 | 1.2 08-08-18-20 | 304C 35# 1.1x18mm |
| 41-320-150240 | SDF-150S 24mm | 24.0 | 27.1 | 20.7 | 0.8 | 0.8 | 23.5mm | 24.5mm | 1.5x0.11x20.7 | 1.2 08-08-18-20 | 304C 35# 1.1x18.5mm |
| 41-320-150245 | SDF-150S 24.5mm | 24.5 | 27.6 | 21.2 | 0.8 | 0.8 | 24.5mm | 25.5mm | 1.5x0.11x21.2 | 1.2 08-08-18-20 | 304C 35# 1.1x19mm |

| | | | | | | | |
|--|-------------------|------------------------|----|---------------------|----|-------------|------------|
| | Objet | Barrette, mod. 5010.01 | | Dessin de | UN | Date | 24.02.2005 |
| | Dessin no. | Unité | mm | Confirmation | | Date | |
| | Matériel | Acier INOX 304 | | | | | |